

IF NOT 25 mm ADJUST SCALES

SCALES SHOWN ARE INTENDED FOR TABLORD (11X17) SIZE DRAWINGS UNLESS NOTED OTHERWISE

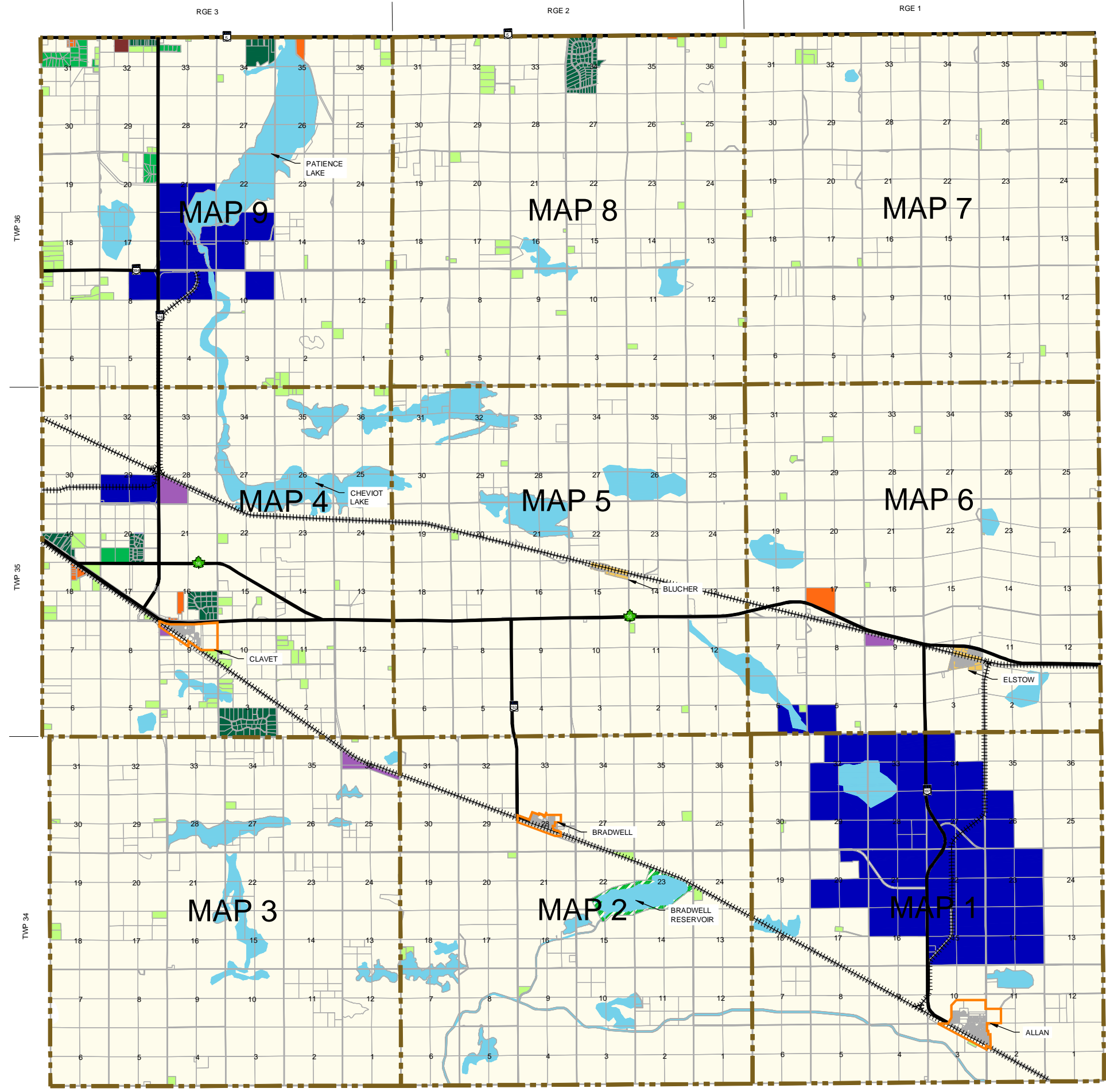

ZONING DISTRICTS

- AR - AGRICULTURAL RESIDENTIAL
- MDR - MEDIUM DENSITY RESIDENTIAL
- HDR - HIGH DENSITY RESIDENTIAL
- H - HAMLET
- MH - MOBILE HOME PARK
- C - COMMERCIAL
- B - BUSINESS
- LI - LIGHT INDUSTRIAL
- HI - HEAVY INDUSTRIAL
- A - AGRICULTURAL
- RD - RESERVOIR DISTRICT
- URBAN BOUNDARY
- PROVINCIAL HIGHWAY
- RAILWAY

THIS IS THE ZONING DISTRICT KEY MAP WHICH ACCOMPANIES BYLAW NUMBER _____ ADOPTED BY THE R.M. OF BLUCHER NO. 343.

REEVE _____

ADMINISTRATOR _____

APPROVED ON THE ____ DAY OF _____

MINISTER SASKATCHEWAN GOVERNMENT OF RELATIONS _____

ZONING DISTRICT KEY MAP

RM OF BLUCHER NO. 343
DIRECTORY MAP

CIVIL
PLANNING
SHEET 1 of 10

AE PROJECT No.	20134287-01
SCALE	N.T.S.
APPROVED	B. DELAINEY
DATE	2016NOV18
REV	A
DESCRIPTION	ISSUED FOR REVIEW



ZONING DISTRICTS

- AR - AGRICULTURAL RESIDENTIAL
- MDR - MEDIUM DENSITY RESIDENTIAL
- HDR - HIGH DENSITY RESIDENTIAL
- H - HAMLET
- MH - MOBILE HOME PARK
- C - COMMERCIAL
- B - BUSINESS
- LI - LIGHT INDUSTRIAL
- HI - HEAVY INDUSTRIAL
- A - AGRICULTURAL
- RD - RESERVOIR DISTRICT
- URBAN BOUNDARY
- PROVINCIAL HIGHWAY
- RAILWAY

THIS IS THE ZONING DISTRICT KEY MAP WHICH ACCOMPANIES BYLAW NUMBER ADOPTED BY THE R.M. OF BLUCHER NO. 343.

REEVE _____

ADMINISTRATOR _____

APPROVED ON THE ____ DAY OF _____

MINISTER
SASKATCHEWAN GOVERNMENT OF RELATIONS

ZONING DISTRICT MAP 1

RM OF BLUCHER NO. 343
TWP 34 - RGE 1 - W3M

CIVIL
PLANNING
SHEET 2 of 10

AE PROJECT No.	20134287-010
SCALE	1:38000
APPROVED	B. DELAINEY
DATE	2016NOV18
REV	A
DESCRIPTION	ISSUED FOR REVIEW

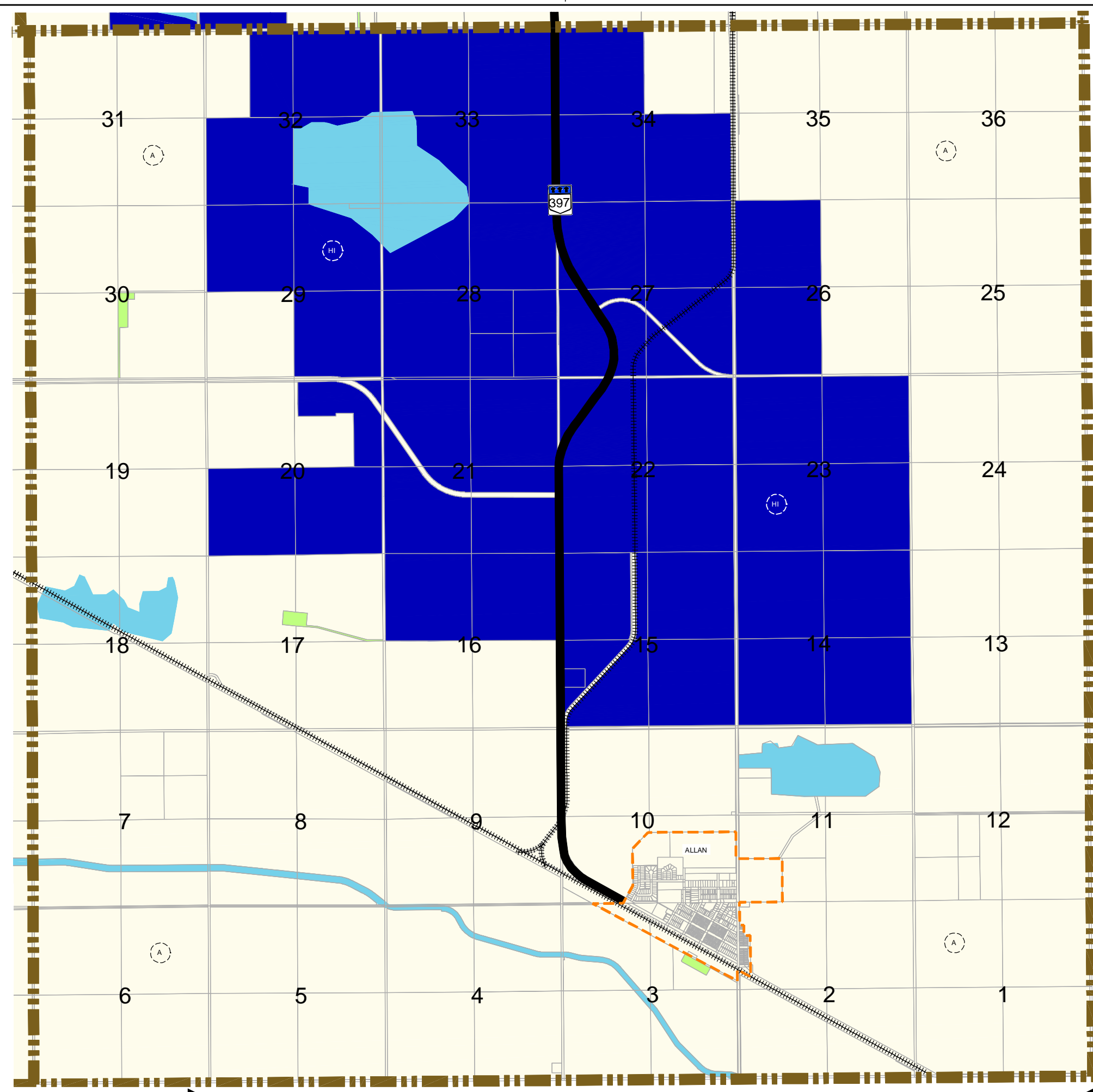

IF NOT 25 mm ADJUST SCALES
SCALE(S) SHOWN ARE INTENDED FOR TABLOID (11x17) SIZE DRAWINGS UNLESS NOTED OTHERWISE



MAP 2 ↑



ZONING DISTRICTS

- AR - AGRICULTURAL RESIDENTIAL
- MDR - MEDIUM DENSITY RESIDENTIAL
- HDR - HIGH DENSITY RESIDENTIAL
- H - HAMLET
- MH - MOBILE HOME PARK
- C - COMMERCIAL
- B - BUSINESS
- LI - LIGHT INDUSTRIAL
- HI - HEAVY INDUSTRIAL
- A - AGRICULTURAL
- RD - RESERVOIR DISTRICT
- URBAN BOUNDARY
- PROVINCIAL HIGHWAY
- RAILWAY

THIS IS THE ZONING DISTRICT KEY MAP WHICH ACCOMPANIES BYLAW NUMBER ADOPTED BY THE R.M. OF BLUCHER NO. 343.

REEVE _____

ADMINISTRATOR _____

APPROVED ON THE ____ DAY OF _____

MINISTER
SASKATCHEWAN GOVERNMENT OF RELATIONS

ZONING DISTRICT MAP 2

RM OF BLUCHER NO. 343
TWP 34 - RGE 2 - W3M

CIVIL
PLANNING
SHEET 3 of 10

AE PROJECT No.	20134287-010
SCALE	1:38000
APPROVED	B. DELAINEY
DATE	2016NOV18
REV	A
DESCRIPTION	ISSUED FOR REVIEW



IF NOT 25 mm ADJUST SCALES
SCALE(S) SHOWN ARE INTENDED FOR TABLOID (11X17) SIZE DRAWINGS UNLESS NOTED OTHERWISE



MAP 3 ↑

MAP 1 ↓



ZONING DISTRICTS

- AR - AGRICULTURAL RESIDENTIAL
- MDR - MEDIUM DENSITY RESIDENTIAL
- HDR - HIGH DENSITY RESIDENTIAL
- H - HAMLET
- MH - MOBILE HOME PARK
- C - COMMERCIAL
- B - BUSINESS
- LI - LIGHT INDUSTRIAL
- HI - HEAVY INDUSTRIAL
- A - AGRICULTURAL
- RD - RESERVOIR DISTRICT
- URBAN BOUNDARY
- PROVINCIAL HIGHWAY
- RAILWAY

THIS IS THE ZONING DISTRICT KEY MAP WHICH ACCOMPANIES BYLAW NUMBER ADOPTED BY THE R.M. OF BLUCHER NO. 343.

REEVE _____

ADMINISTRATOR _____

APPROVED ON THE ____ DAY OF _____

MINISTER
SASKATCHEWAN GOVERNMENT OF RELATIONS

ZONING DISTRICT MAP 3

RM OF BLUCHER NO. 343
TWP 34 - RGE 3 - W3M

CIVIL
PLANNING
SHEET 4 of 10

AE PROJECT No.	20134287-010
SCALE	1:38000
APPROVED	B. DELAINEY
DATE	2016NOV18
REV	A
DESCRIPTION	ISSUED FOR REVIEW

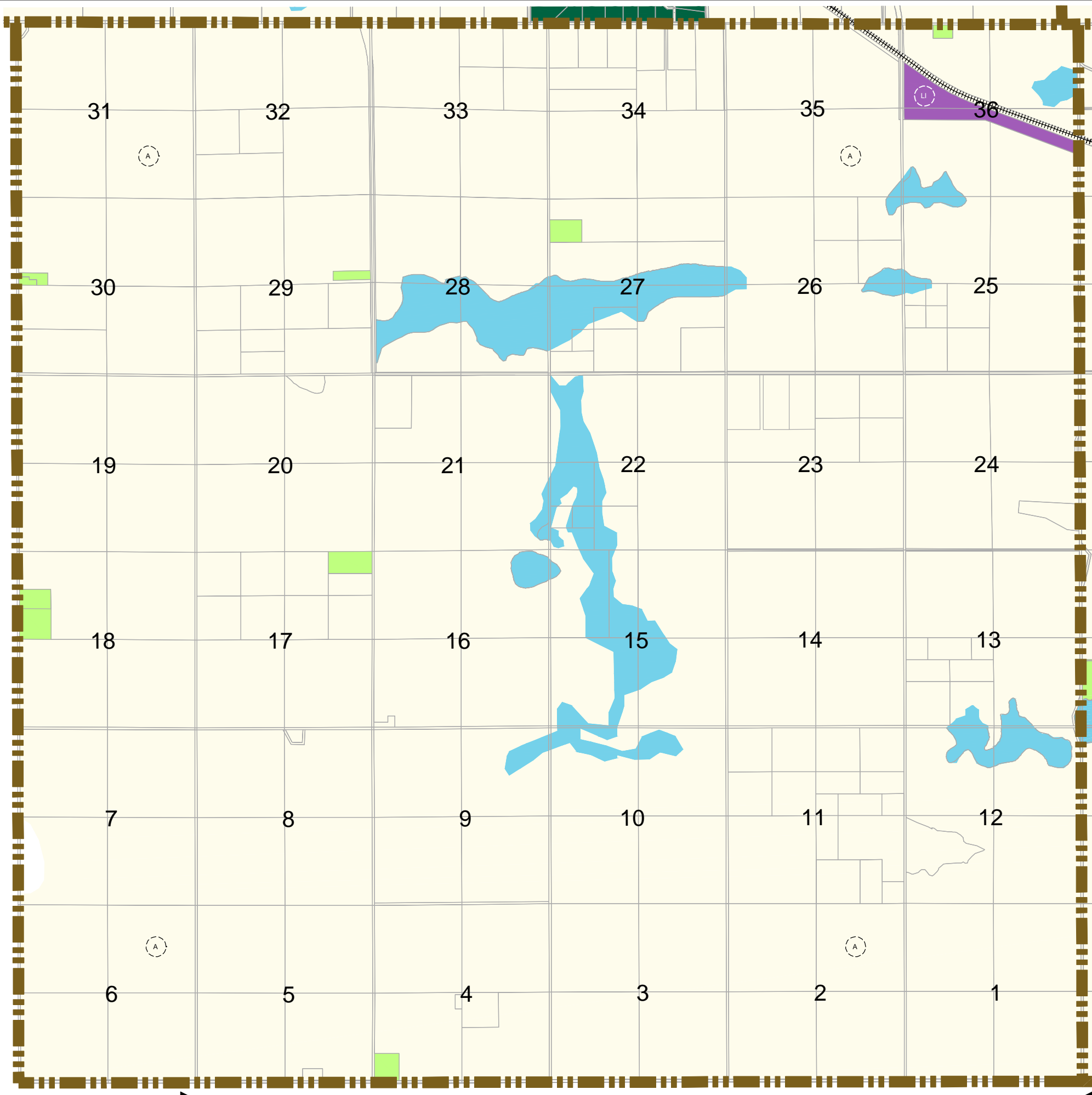

IF NOT 25 mm ADJUST SCALES

SCALE(S) SHOWN ARE INTENDED FOR TABLOID (11X17) SIZE DRAWINGS UNLESS NOTED OTHERWISE

MAP 2 ↓



ZONING DISTRICTS

- AR - AGRICULTURAL RESIDENTIAL
- MDR - MEDIUM DENSITY RESIDENTIAL
- HDR - HIGH DENSITY RESIDENTIAL
- H - HAMLET
- MH - MOBILE HOME PARK
- C - COMMERCIAL
- B - BUSINESS
- LI - LIGHT INDUSTRIAL
- HI - HEAVY INDUSTRIAL
- A - AGRICULTURAL
- RD - RESERVOIR DISTRICT
- URBAN BOUNDARY
- PROVINCIAL HIGHWAY
- RAILWAY

THIS IS THE ZONING DISTRICT KEY MAP WHICH ACCOMPANIES BYLAW NUMBER _____ ADOPTED BY THE R.M. OF BLUCHER NO. 343.

REEVE _____

ADMINISTRATOR _____

APPROVED ON THE ____ DAY OF _____

MINISTER
SASKATCHEWAN GOVERNMENT OF RELATIONS

ZONING DISTRICT MAP 4

RM OF BLUCHER NO. 343
TWP 35 - RGE 3 - W3M

CIVIL
PLANNING
SHEET 5 of 10

AE PROJECT No.	20134287-010
SCALE	1:38000
APPROVED	B. DELAINEY
DATE	2016NOV18
REV	A
DESCRIPTION	ISSUED FOR REVIEW

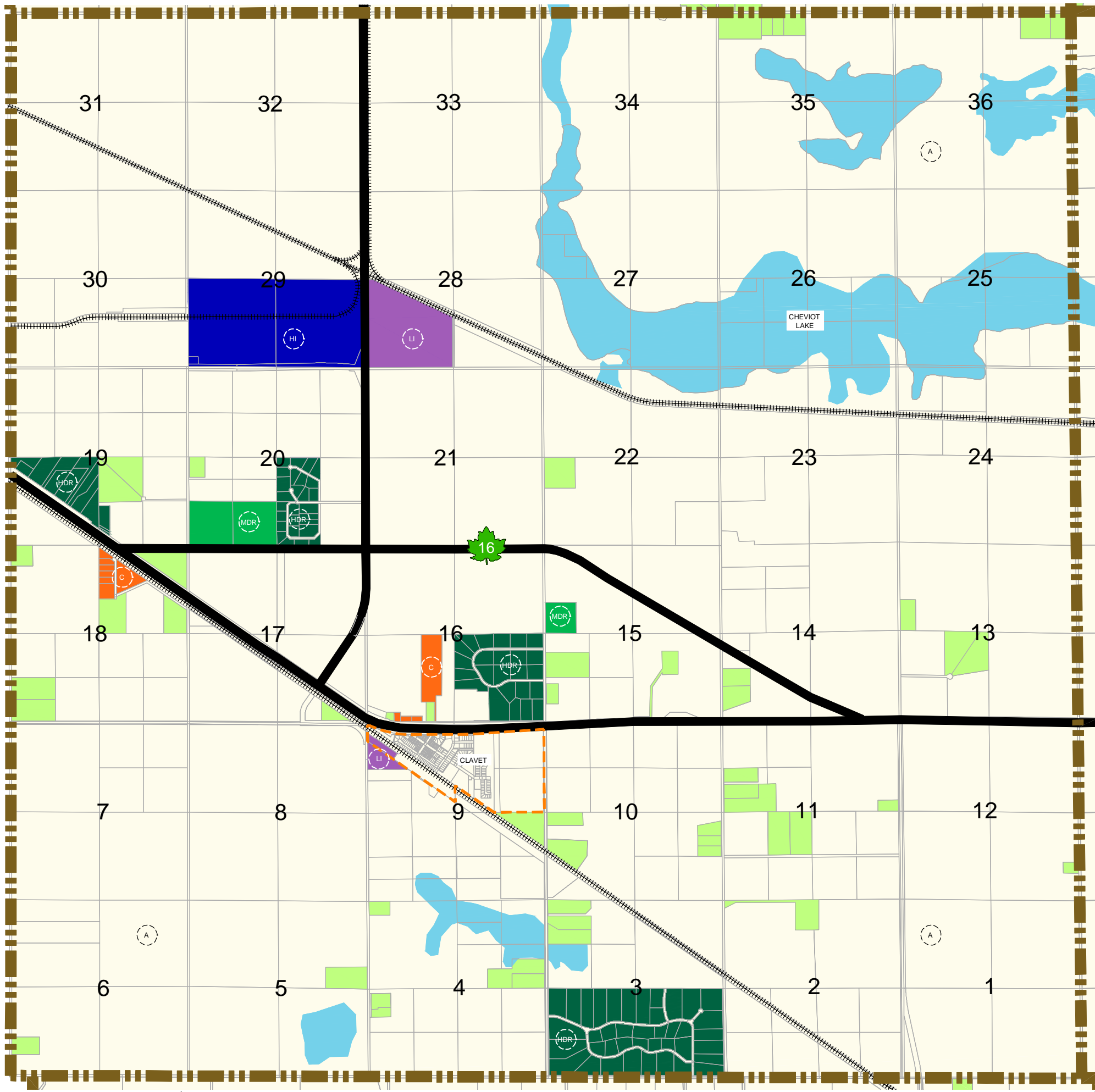

MAP 5 ↓

IF NOT 25 mm ADJUST SCALES

SCALE(S) SHOWN ARE INTENDED FOR TABLOID (11X17) SIZE DRAWINGS UNLESS NOTED OTHERWISE



ZONING DISTRICTS

- AR - AGRICULTURAL RESIDENTIAL
- MDR - MEDIUM DENSITY RESIDENTIAL
- HDR - HIGH DENSITY RESIDENTIAL
- H - HAMLET
- MH - MOBILE HOME PARK
- C - COMMERCIAL
- B - BUSINESS
- LI - LIGHT INDUSTRIAL
- HI - HEAVY INDUSTRIAL
- A - AGRICULTURAL
- RD - RESERVOIR DISTRICT
- URBAN BOUNDARY
- PROVINCIAL HIGHWAY
- RAILWAY

THIS IS THE ZONING DISTRICT KEY MAP WHICH ACCOMPANIES BYLAW NUMBER _____ ADOPTED BY THE R.M. OF BLUCHER NO. 343.

REEVE _____

ADMINISTRATOR _____

APPROVED ON THE ____ DAY OF _____

MINISTER
SASKATCHEWAN GOVERNMENT OF RELATIONS

ZONING DISTRICT MAP 5

RM OF BLUCHER NO. 343
TWP 35 - RGE 2 - W3M

CIVIL
PLANNING
SHEET 6 of 10

AE PROJECT No.	20134287-010
SCALE	1:38000
APPROVED	B. DELAINEY
DATE	2016NOV18
REV	A
DESCRIPTION	ISSUED FOR REVIEW

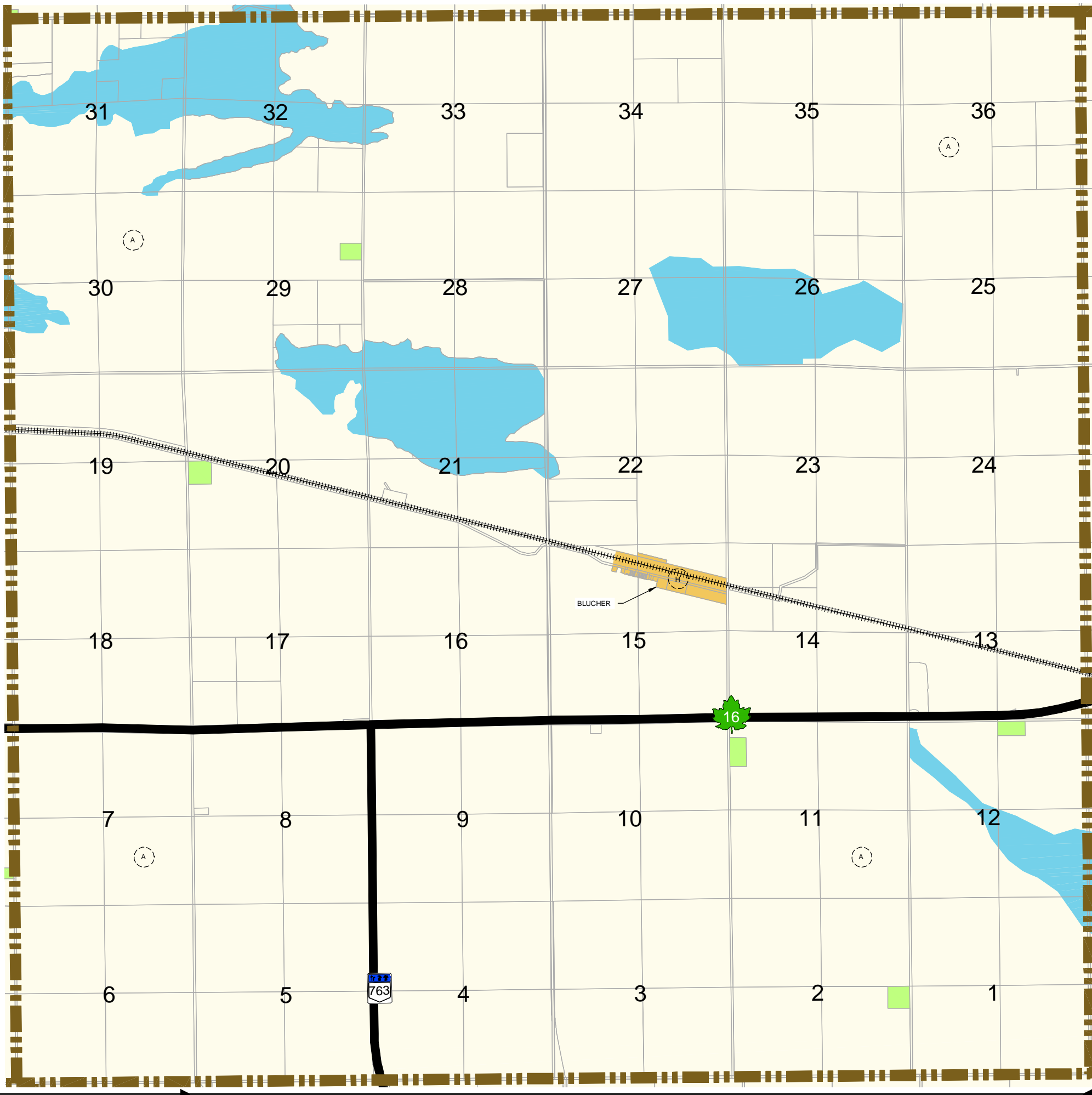

IF NOT 25 mm ADJUST SCALES

SCALES SHOWN ARE INTENDED FOR TABLOID (11X17) SIZE DRAWINGS UNLESS NOTED OTHERWISE



MAP 4 ↑

MAP 6 ↓



ZONING DISTRICTS

- AR - AGRICULTURAL RESIDENTIAL
- MDR - MEDIUM DENSITY RESIDENTIAL
- HDR - HIGH DENSITY RESIDENTIAL
- H - HAMLET
- MH - MOBILE HOME PARK
- C - COMMERCIAL
- B - BUSINESS
- LI - LIGHT INDUSTRIAL
- HI - HEAVY INDUSTRIAL
- A - AGRICULTURAL
- RD - RESERVOIR DISTRICT
- URBAN BOUNDARY
- PROVINCIAL HIGHWAY
- RAILWAY

THIS IS THE ZONING DISTRICT KEY MAP WHICH ACCOMPANIES BYLAW NUMBER _____ ADOPTED BY THE R.M. OF BLUCHER NO. 343.

REEVE _____

ADMINISTRATOR _____

APPROVED ON THE ____ DAY OF _____

MINISTER SASKATCHEWAN GOVERNMENT OF RELATIONS _____

ZONING DISTRICT MAP 6

RM OF BLUCHER NO. 343
TWP 35 - RGE 1 - W3M

CIVIL
PLANNING
SHEET 7 of 10

AE PROJECT No.	20134287-010
SCALE	1:38000
APPROVED	B. DELAINEY
DATE	2016NOV18
REV	A
DESCRIPTION	ISSUED FOR REVIEW

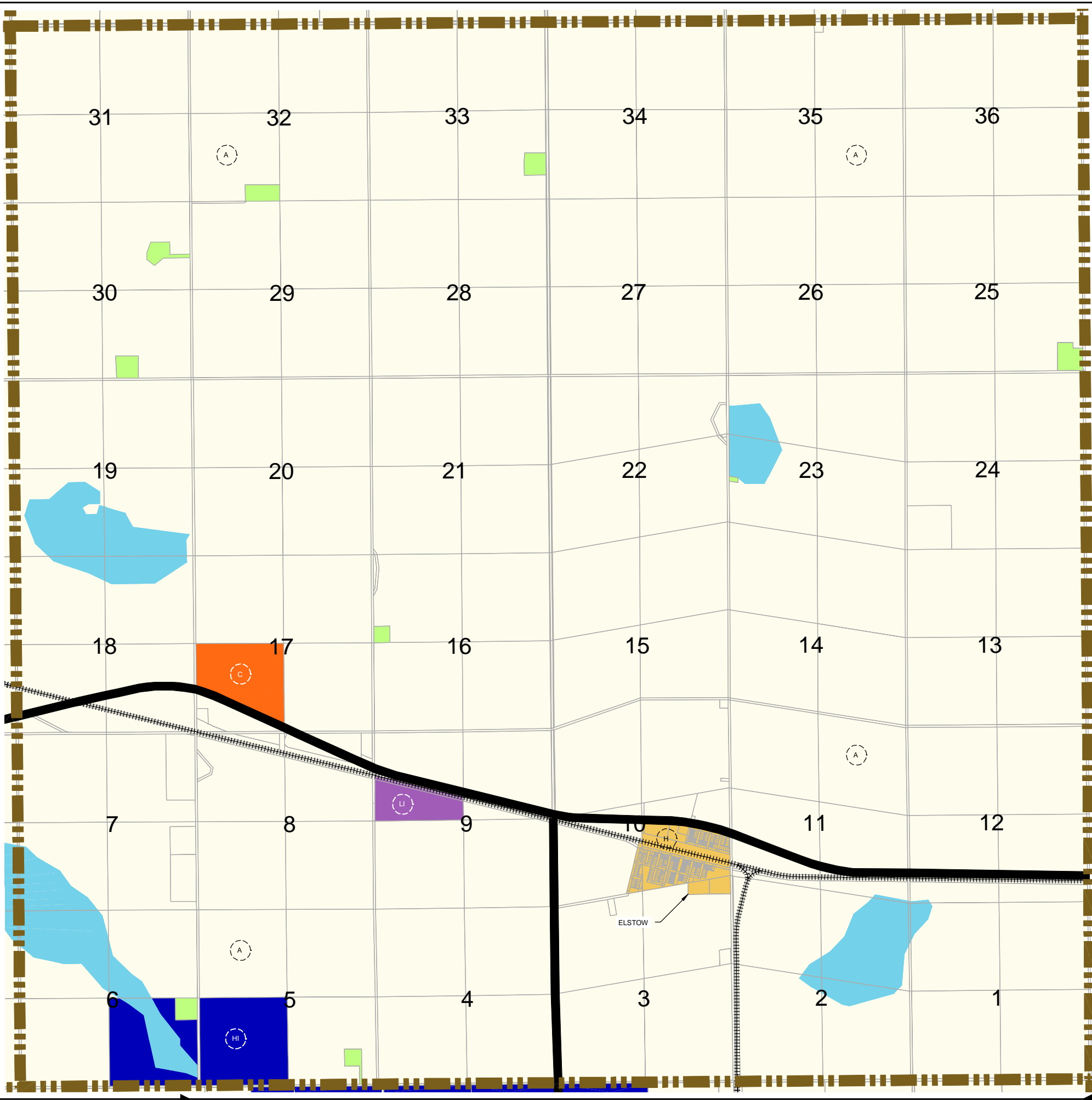

MAP 5 ↑



IF NOT 25 mm ADJUST SCALES

SCALE(S) SHOWN ARE INTENDED FOR TABLOID (11X17) SIZE DRAWINGS UNLESS NOTED OTHERWISE

IF NOT 25 mm ADJUST SCALES

SCALE(S) SHOWN ARE INTENDED FOR TABLOID (11x17) SIZE DRAWINGS UNLESS NOTED OTHERWISE



MAP 8 ↑

MAP 6 ↓

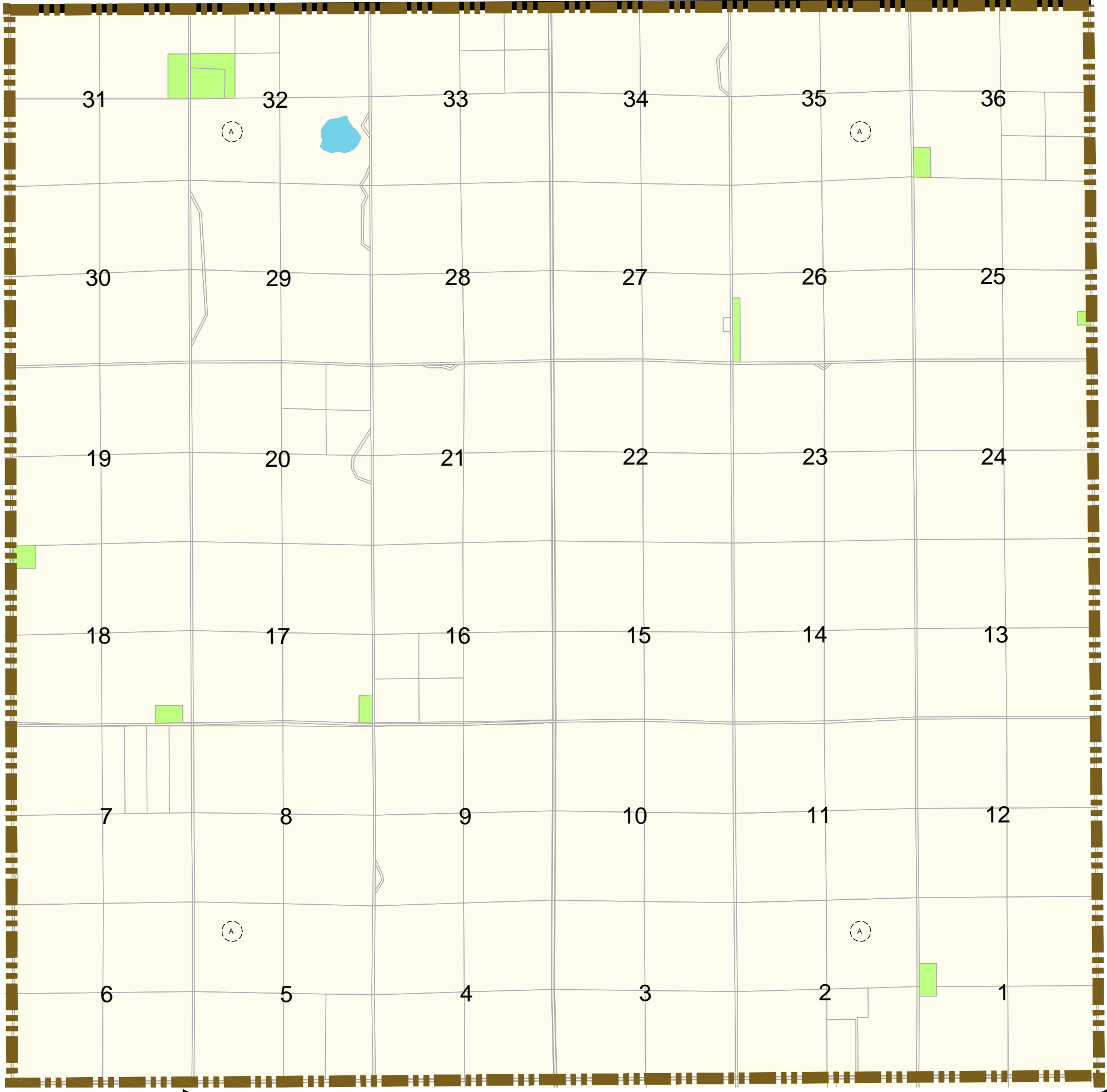

ZONING DISTRICTS

- AR - AGRICULTURAL RESIDENTIAL
- MDR - MEDIUM DENSITY RESIDENTIAL
- HDR - HIGH DENSITY RESIDENTIAL
- H - HAMLET
- MH - MOBILE HOME PARK
- C - COMMERCIAL
- B - BUSINESS
- LI - LIGHT INDUSTRIAL
- HI - HEAVY INDUSTRIAL
- A - AGRICULTURAL
- RD - RESERVOIR DISTRICT
- URBAN BOUNDARY
- PROVINCIAL HIGHWAY
- RAILWAY

THIS IS THE ZONING DISTRICT KEY MAP WHICH ACCOMPANIES BYLAW NUMBER _____ ADOPTED BY THE R.M. OF BLUCHER NO. 343.

REEVE _____

ADMINISTRATOR _____

APPROVED ON THE ____ DAY OF _____

MINISTER
SASKATCHEWAN GOVERNMENT OF RELATIONS

ZONING DISTRICT MAP 7

RM OF BLUCHER NO. 343
TWP 36 - RGE 1 - W3M

CIVIL
PLANNING
SHEET 8 of 10

AE PROJECT No.	20134287-010
SCALE	1:38000
APPROVED	B. DELAINEY
DATE	2016NOV18
REV	A
DESCRIPTION	ISSUED FOR REVIEW

IF NOT 25 mm ADJUST SCALES

SCALE(S) SHOWN ARE INTENDED FOR TABLORD (11X17) SIZE DRAWINGS UNLESS NOTED OTHERWISE



MAP 9 ↑

MAP 7 ↓

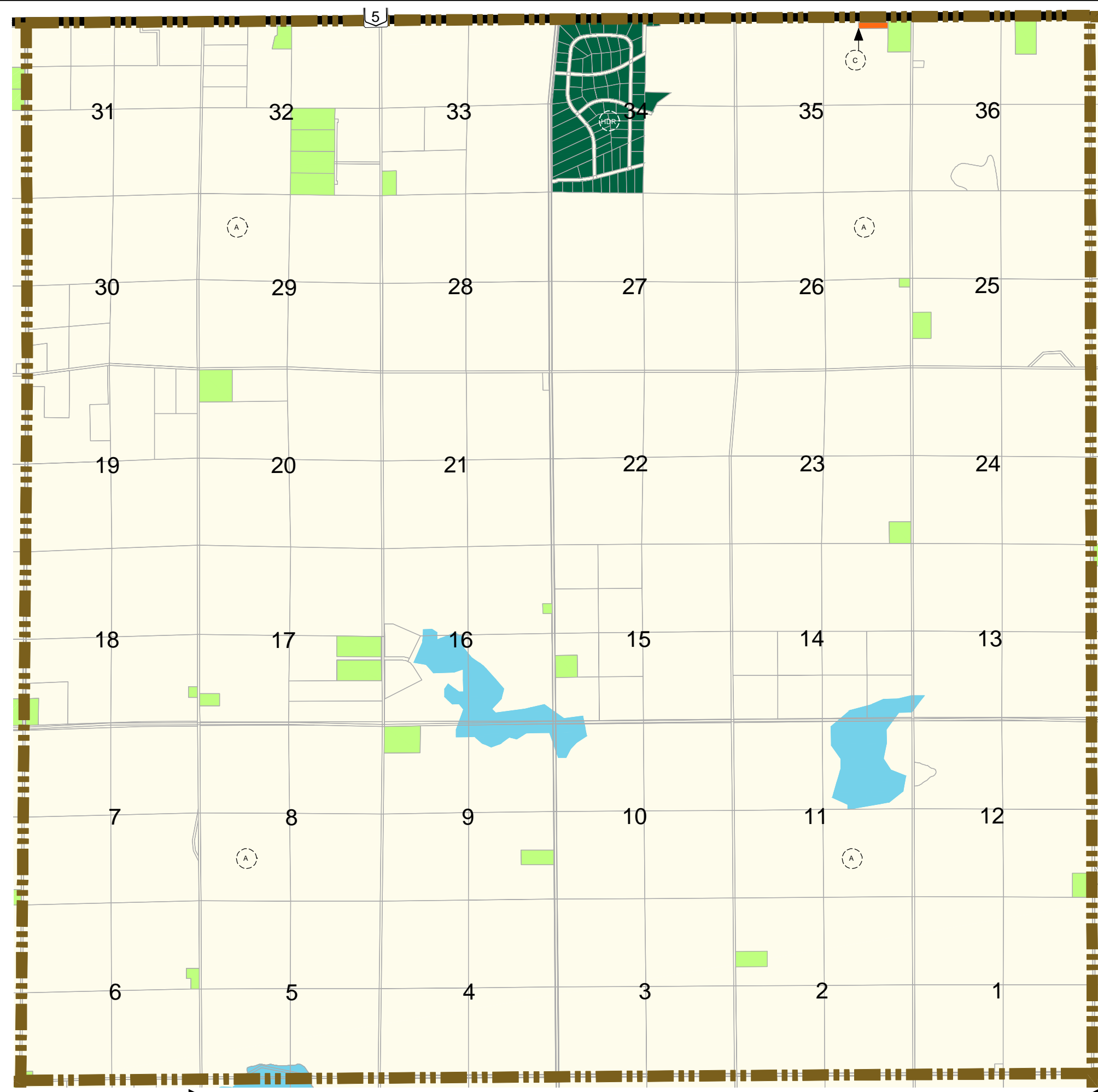

MAP 5 ↓



ZONING DISTRICTS

- AR - AGRICULTURAL RESIDENTIAL
- MDR - MEDIUM DENSITY RESIDENTIAL
- HDR - HIGH DENSITY RESIDENTIAL
- H - HAMLET
- MH - MOBILE HOME PARK
- C - COMMERCIAL
- B - BUSINESS
- LI - LIGHT INDUSTRIAL
- HI - HEAVY INDUSTRIAL
- A - AGRICULTURAL
- RD - RESERVOIR DISTRICT
- URBAN BOUNDARY
- PROVINCIAL HIGHWAY
- RAILWAY

THIS IS THE ZONING DISTRICT KEY MAP WHICH ACCOMPANIES BYLAW NUMBER _____ ADOPTED BY THE R.M. OF BLUCHER NO. 343.

REEVE _____

ADMINISTRATOR _____

APPROVED ON THE ____ DAY OF _____

MINISTER
SASKATCHEWAN GOVERNMENT OF RELATIONS

ZONING DISTRICT MAP 8

RM OF BLUCHER NO. 343
TWP 26 - RGE 2 - W3M

CIVIL
PLANNING
SHEET 9 of 10

AE PROJECT No.	20134287-010
SCALE	1:38000
APPROVED	B. DELAINEY
DATE	2016NOV18
REV	A
DESCRIPTION	ISSUED FOR REVIEW

IF NOT 25 mm ADJUST SCALES

SCALE(S) SHOWN ARE INTENDED FOR TABLOID (11x17) SIZE DRAWINGS UNLESS NOTED OTHERWISE

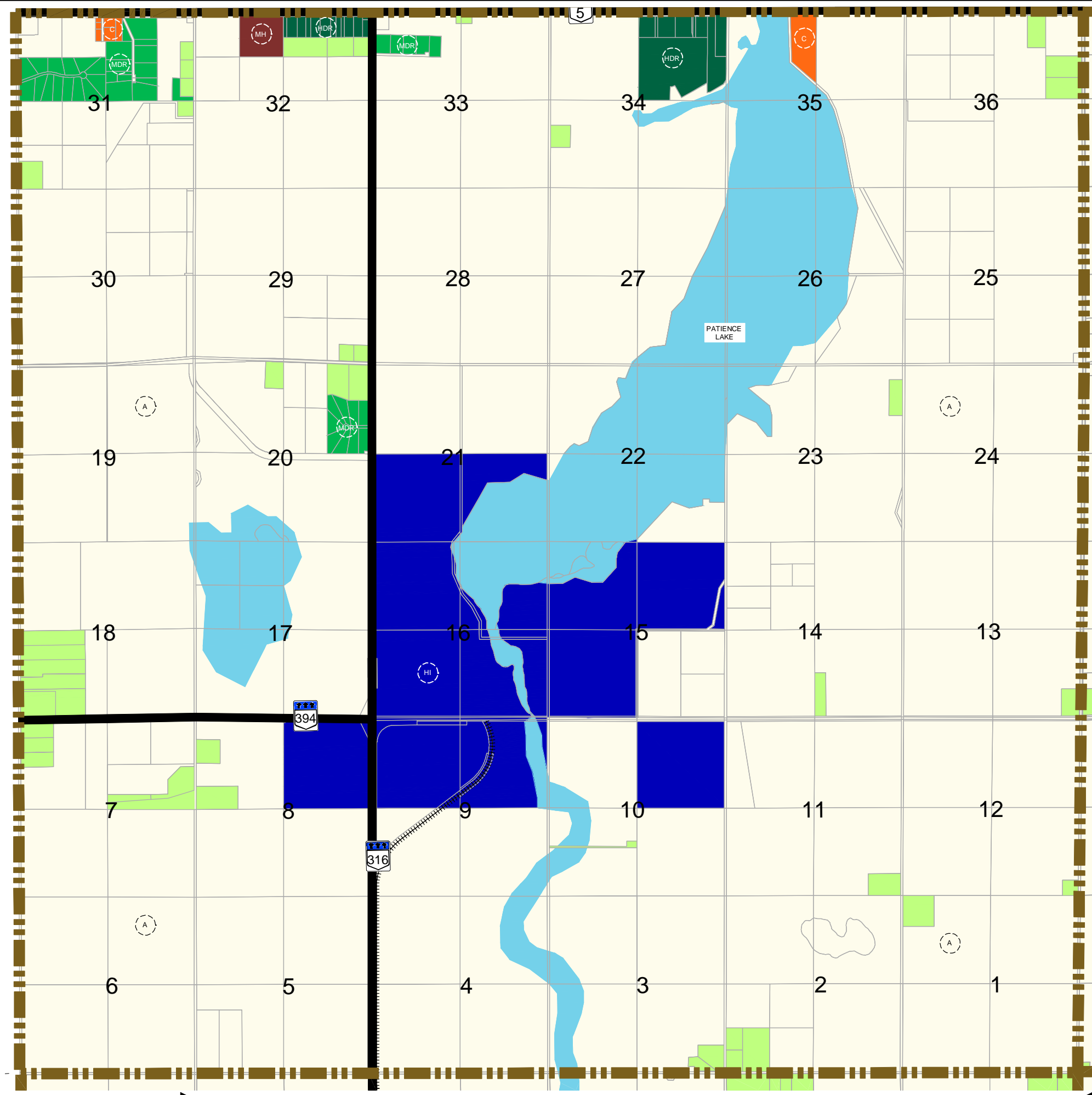

MAP 4 ↓

MAP 8 ↑



ZONING DISTRICTS

- AR - AGRICULTURAL RESIDENTIAL
- MDR - MEDIUM DENSITY RESIDENTIAL
- HDR - HIGH DENSITY RESIDENTIAL
- H - HAMLET
- MH - MOBILE HOME PARK
- C - COMMERCIAL
- B - BUSINESS
- LI - LIGHT INDUSTRIAL
- HI - HEAVY INDUSTRIAL
- A - AGRICULTURAL
- RD - RESERVOIR DISTRICT
- URBAN BOUNDARY
- PROVINCIAL HIGHWAY
- RAILWAY

THIS IS THE ZONING DISTRICT KEY MAP WHICH ACCOMPANIES BYLAW NUMBER _____ ADOPTED BY THE R.M. OF BLUCHER NO. 343.

REEVE _____

ADMINISTRATOR _____

APPROVED ON THE ____ DAY OF _____

MINISTER
SASKATCHEWAN GOVERNMENT OF RELATIONS

ZONING DISTRICT MAP 9

RM OF BLUCHER NO. 343
TWP 36 - RGE 3 - W3M

CIVIL
PLANNING
SHEET 10 of 10

AE PROJECT No.	20134287-010
SCALE	1:38000
APPROVED	B. DELAINEY
DATE	2016NOV18
REV	A
DESCRIPTION	ISSUED FOR REVIEW